



**THE CORPORATION OF THE
TOWN OF MIDLAND**

575 Dominion Avenue
Midland, ON L4R 1R2
Phone: 705-526-4275
Fax: 705-526-9971
www.midland.ca

**NOTICE OF PUBLIC HEARING - SIGN VARIANCE COMMITTEE
Sign Variance Application C.3/2019**

In the matter of the *Municipal Act, S.O. Chapter 25, Section 99(9)* and Sign By-law 2011-79, as amended, being a By-law to regulate Signs or Other Advertising Devices, please be advised that:

TAKE NOTICE that an application to the Sign Variance Committee has been submitted for a variance to the Sign By-law 2011-79, as amended, pursuant to Part 9.1.5 under the Sign By-law 2011-79, as amended, for lands known municipally as **9225 County Road 93 (Huron Mall)**.

The property is designated Employment Area in the Official Plan and zoned Highway Commercial - HC in Zoning By-law 2004-90, as amended.

THE PURPOSE OF THE APPLICATION is for a variance to section 8.2.3 b) of the Sign By-law to permit a fascia sign with a sign area of 19.33 square metres whereas the By-law requires a maximum sign area of 4.0 square metres. A location map and application sketch is provided on the back of this Notice.

The Sign Variance Committee will hold a Public Hearing on **Thursday, June 13, 2019 at 4:30 p.m.** or as soon thereafter as practical in the Council Chambers of the Municipal Building, 575 Dominion Avenue, Midland to consider this application.

This is a Public Hearing and persons wishing to support or oppose this application are permitted to attend, or if unable to attend, may submit comments in writing to the Secretary-Treasurer of the Committee or via e-mail to planning@midland.ca, indicating the application number and address of the property, prior to the date and time of the Hearing. When complete, and at least 5 days prior to the hearing, staff reports will be made available to the public and can be found on the Town's website at: <https://www.midland.ca/Pages/Sign-Variance-Committee.aspx>. For more information about this matter, contact the Planning and Building Services Department during regular business hours.

AND FURTHER TAKE NOTICE that pursuant to Section 253(1) of the *Municipal Act*, the Application file is part of the public record and is available to the public for inspection. If you are submitting letters, faxes, emails, presentations or other communications with the Town concerning this application, you should be aware that your name and the fact you communicated with the Town will become part of the public record. The Town will also make your communication and any personal information in it available to the public, unless you expressly request the Town to remove it. A copy of the decision of the Sign Variance Committee will be sent to the applicant and to each person who appeared in person or by counsel at the hearing and who filed with the Secretary-Treasurer a written request for a copy of the Notice of Decision.

Dated this 30th day of May, 2019.

Natalie Murdock
Secretary-Treasurer, Midland Sign Variance Committee

*Please see the opposite side
of this Notice for more information*



THE CORPORATION OF THE TOWN OF MIDLAND

575 Dominion Avenue
Midland, ON L4R 1R2
Phone: 705-526-4275
Fax: 705-526-9971
www.midland.ca

Sign Variance Application C.3/2019

Location Map

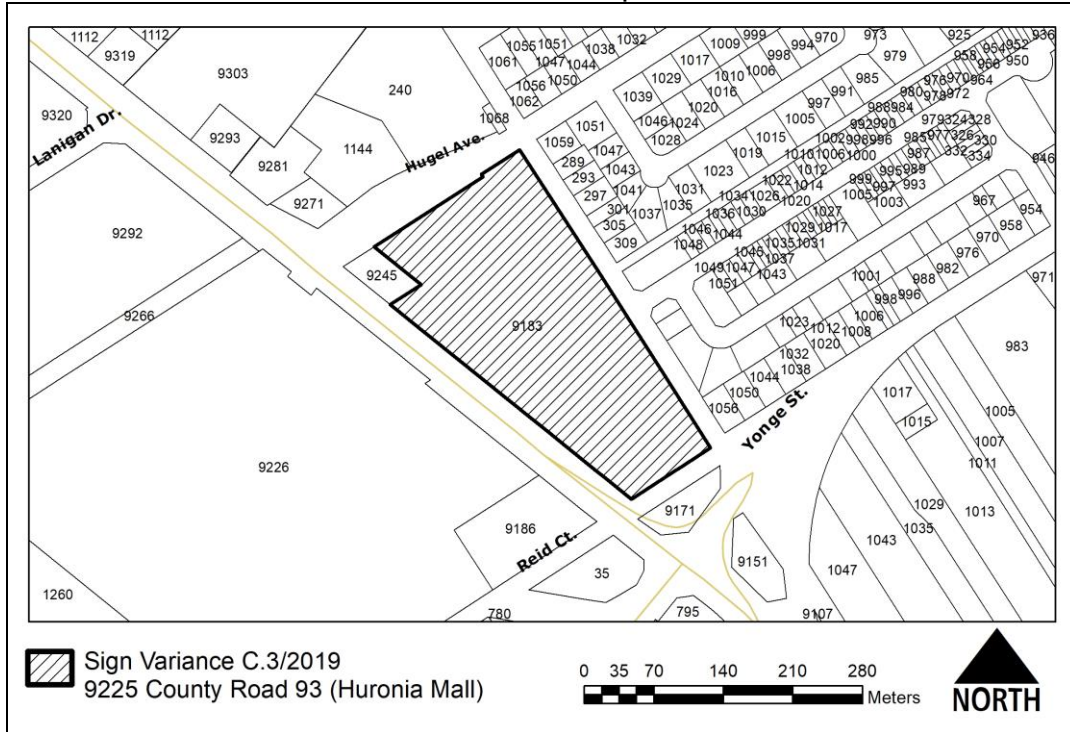

Application sketch

Client: Bulk Barn - 550
Location: Wyebridge, On

120V 347V

Preliminary Artwork
site check required prior to manufacturing

Photo Note
The representation of the signage contained on this page is for illustrative purposes only and may not accurately reflect the final sign system. Applicant shall be responsible for the design. Lovett Signs shall not be responsible for the design or construction of the signage system or any aspects of the signage system that are not the actual signage itself.

proposed side elevation

SIDE ELEVATION PAINTED BY OTHERS

656" (16.66m)

SOUTH WEST (front) ELEVATION - 1125.22 sq/ft (104.54 sq/m)

existing side elevation

Wall painted and repaired by others

existing signage

Alfie Zagar REVIEWED | Jason Ofield APPROVED | Craig Ofield APPROVED | Project Manager APPROVED | Landlord APPROVED

www.lovettsigns.ca

Client: Bulk Barn
Address: 9225 County Rd 93, Wyebridge, On
Designer: FJ
Start Date: July 4, 2017
Revision Date: Nov 27, 2018
Scale: 1/8" = 1' layout

LovettSigns 80

525 Southgate Dr., Guelph, ON
T: 519-822-3558
F: 519-822-2075
E: sales@lovettsigns.ca

Drawing # | BB Midland Prod ID
Illumination | yes no
Site checked | yes no

All artistic renderings copyright Lovett Signs & Neon Inc. A minimum of \$500 will be charged if this artistic rendering is used in whole or in part without written consent.

Please see the opposite side of this Notice for more information